

PARTS LIST

**XM Radio Attachment (sold separately):
P/N 08B15-SNA-100A**

Bus cable

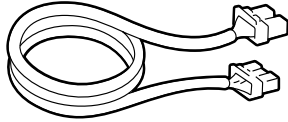

Bracket

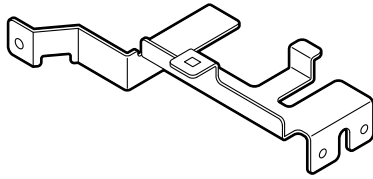

Turn nut



Clip



Rubber

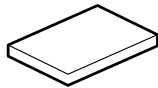

4 Pan screws

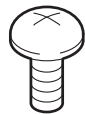

4 Washers



Flange bolt



Washer-screw



Cover seal

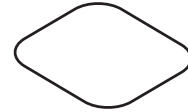

6 Wire ties

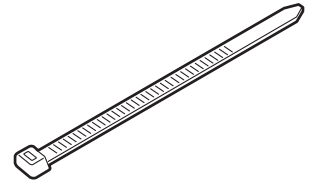

2 Wire ties with clip

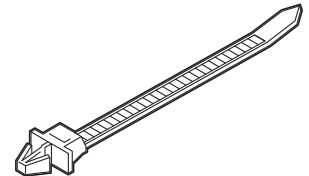

6 Cushion tapes

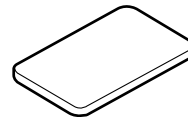

3 EPT sealers
(Some may not be used.)

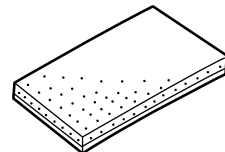

**XM Antenna (sold separately):
P/N 08A15-0J1-100**

Antenna Assy

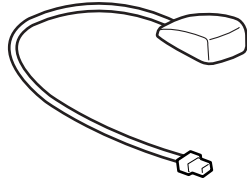

**Unit (sold separately):
P/N 08A15-3J1-000**

XM radio unit

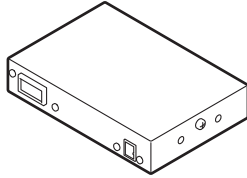

**2-Port bus cable (sold separately):
P/N 08A31-0F1-000**

2-Port bus cable

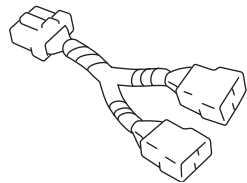

TOOLS AND SUPPLIES REQUIRED

- Phillips screwdriver
- Flat-tip screwdriver
- Shop towel
- Scissors
- Ratchet
- 10 mm Socket
- 10 mm Combination wrench
- Isopropyl alcohol
(Isopropyl alcohol, in a 60/40 solution with water)
- Rubber mallet
- Masking tape
- TORX bit
- Drill
- 3 mm and 8 mm Drill bits
- Eye protection (Safety goggles, face shield, etc.)
- Ruler
- Plastic Trim Tool (T/N SILTRIMTL10)
- Diagonal cutters
- Duct tape

Illustration of the XM Radio System Installed on the Vehicle

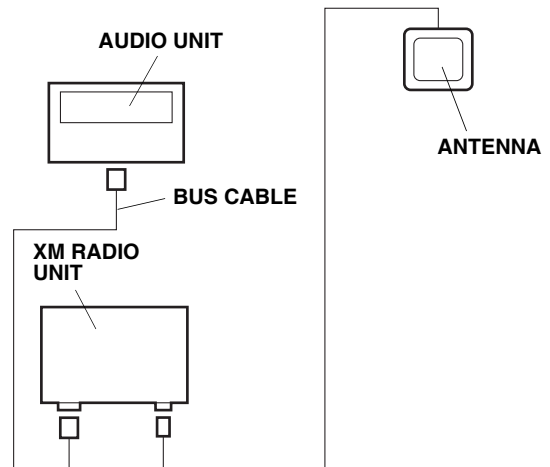
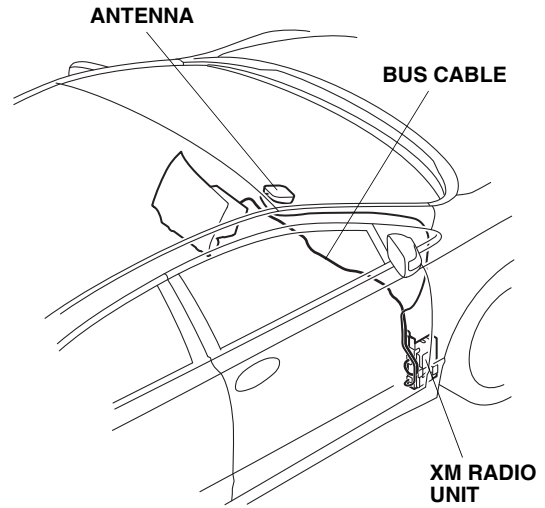

INSTALLATION

Customer Information: The information in this installation instruction is intended for use only by skilled technicians who have the proper tools, equipment, and training to correctly and safely add equipment to your vehicle. These procedures should not be attempted by “do-it-yourselfers.”

1. Make sure you have the anti-theft codes for the audio and navigation system (if equipped), then write down the audio presets.
2. Disconnect the negative cable from the battery.
3. Remove the passenger's dashboard under cover (four clips and two pins).

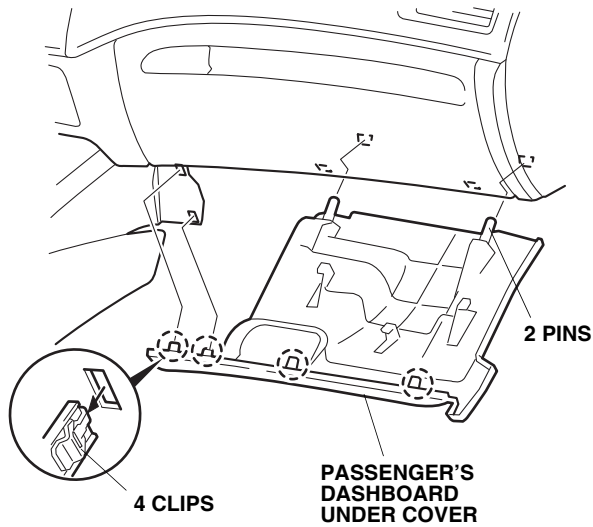

4. Remove the two bolts under the glove box.

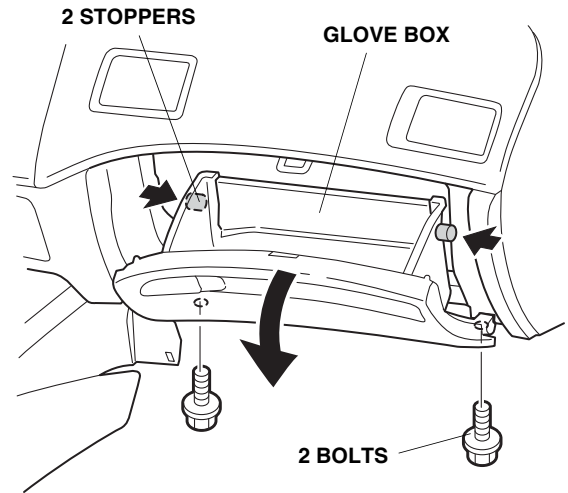

5. Open and remove the glove box (two stoppers).
6. Remove the driver's dashboard lower cover (eight clips).

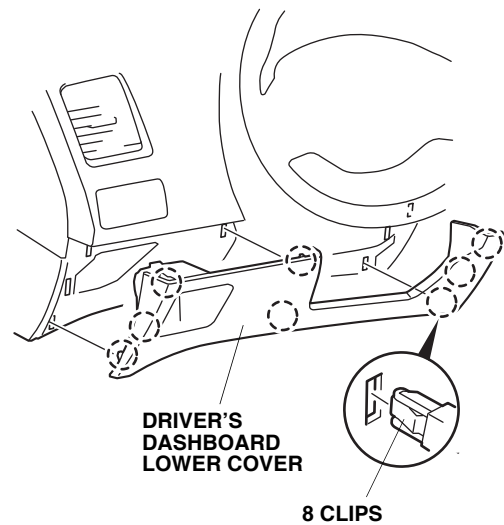

- Remove the inside cover from the front console pocket (two tabs).

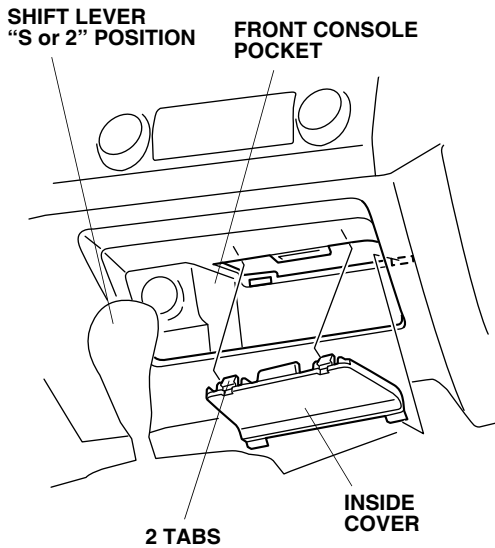

- Lower the tilt lever, then pull the steering wheel toward you.

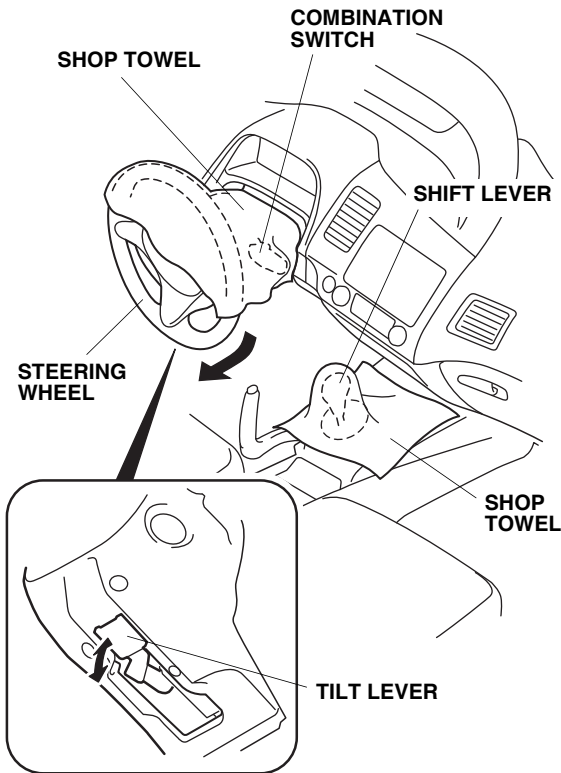

- To protect the dashboard area, put shop towels over the steering wheel and shift lever.

- Apply masking tape to the instrument panel as shown, and remove the meter panel (one self-tapping screw, and 11 clips, and unplug the vehicle connectors).

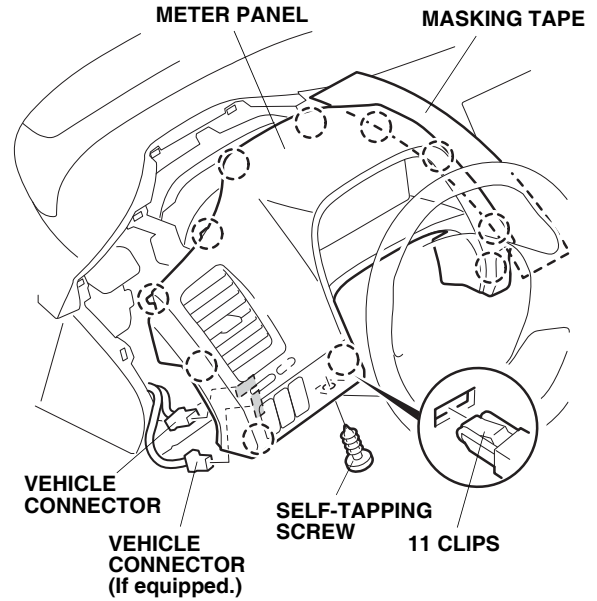

- Apply masking tape to the instrument panel as shown. Remove the center panel (two bolts, 11 clips, and aspirator hose, and unplug the vehicle connectors).

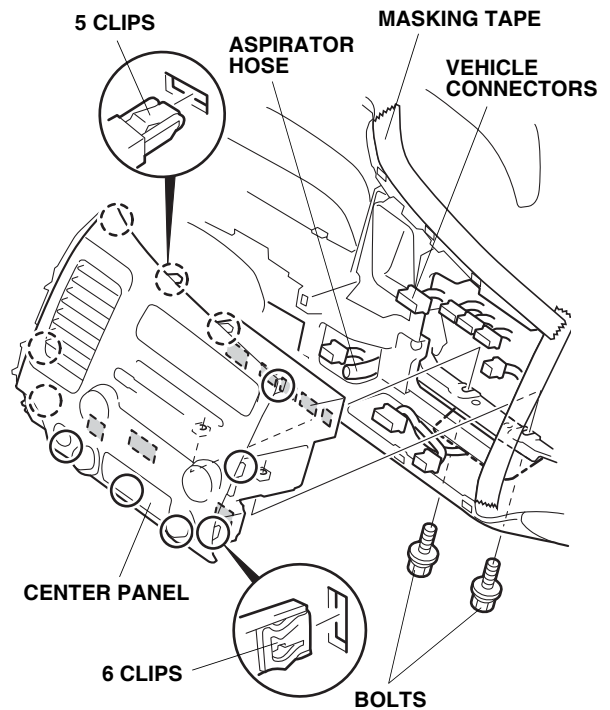

12. Pull the weatherstrip off in the area shown.

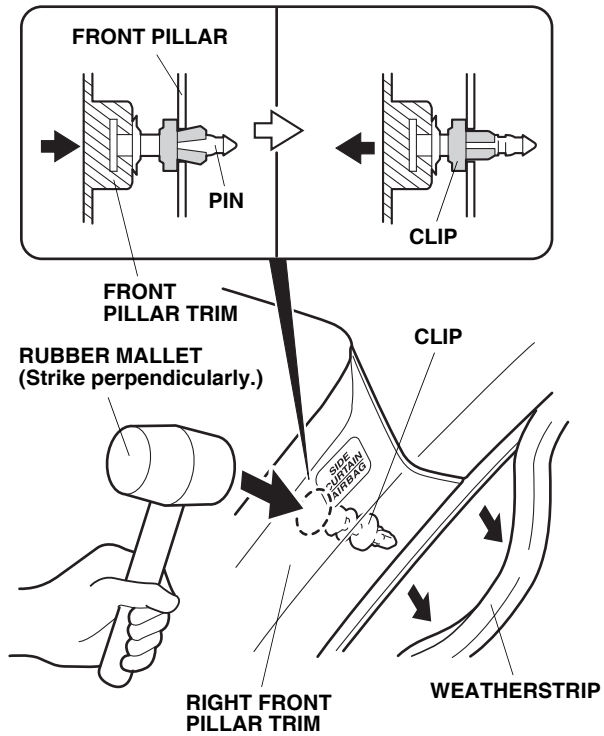

13. Push the clip into the vehicle side by striking the top of the right front pillar trim in the part marked as "SIDE CURTAIN AIRBAG" with the rubber mallet perpendicularly to the vehicle. Then, remove the clip.

14. Pull the weatherstrip off in the area shown. And remove the right front pillar trim (two clips).

4-door vehicle:

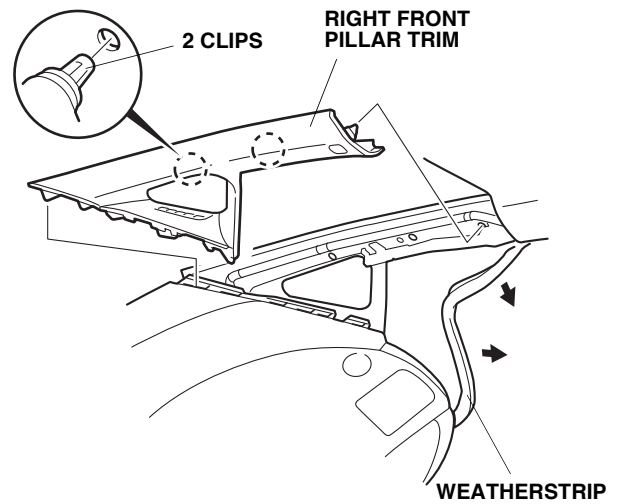

2-door vehicle:

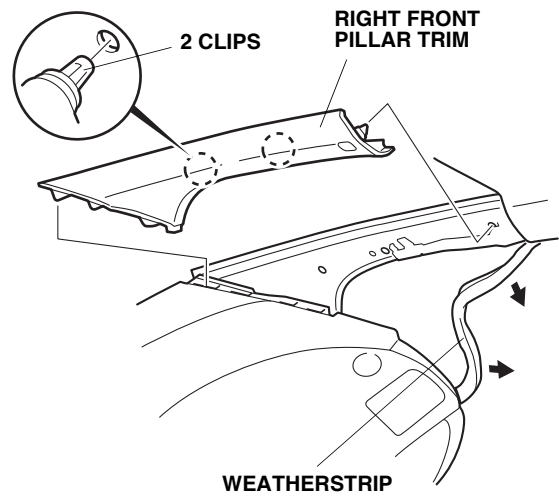

- Remove the cap from the right sunvisor (four retaining tabs).

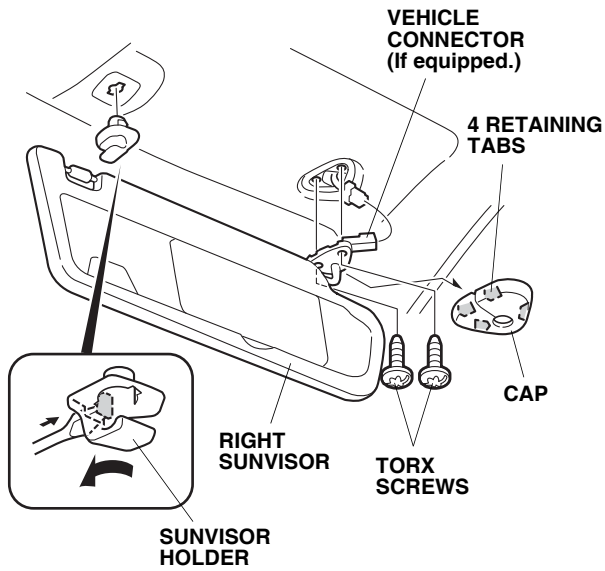

- Remove the right sunvisor (two T25 TORX screws, and unplug the vehicle connector, if equipped).
- Remove the sunvisor holder. Turn the holder 90°, then pull it out.
- Remove the right front door sill trim (three tabs, five clips, and five hooks).

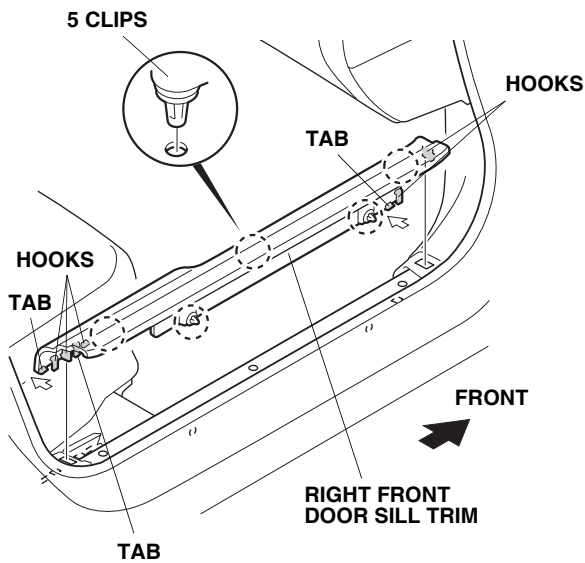

- Pull the weatherstrip off, then remove the right kick panel (two clips).

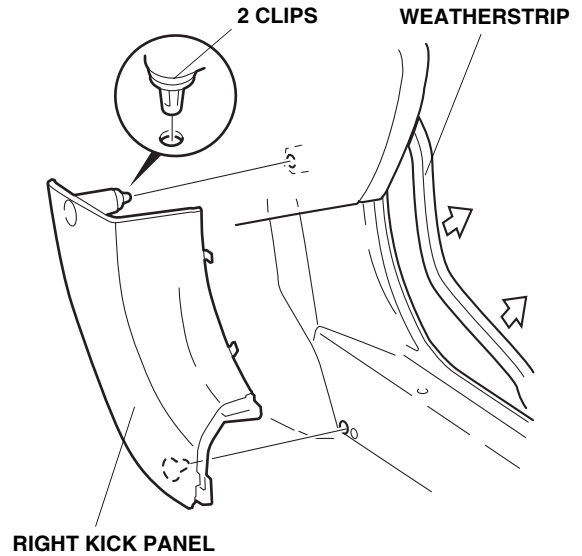

Installing the XM Radio Unit

- Using four pan screws and four washers, secure the bracket to the XM radio unit.

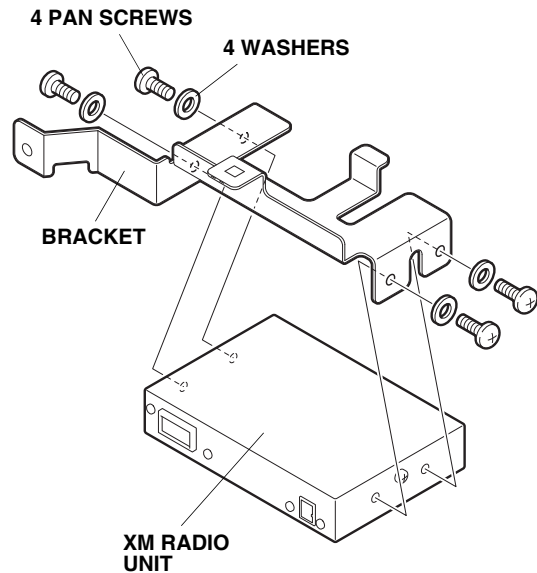

21. Attach the rubber to the vehicle panel in the area shown after cleaning with isopropyl alcohol on a shop towel.

- 4-door vehicle: Skip step 22.
- 2-door vehicle: Perform step 22.

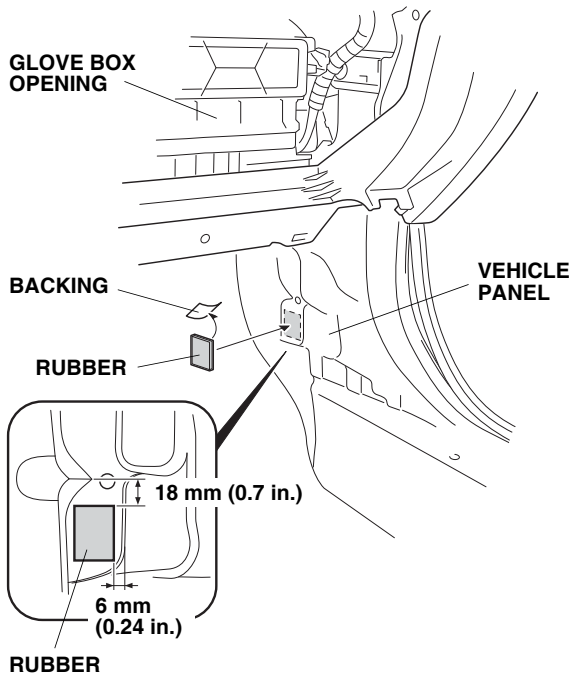

22. **2-door vehicle only:**

Wearing eye protection, drill through the dimple on the vehicle panel with 3 mm and then 8 mm drill bits duct taped.

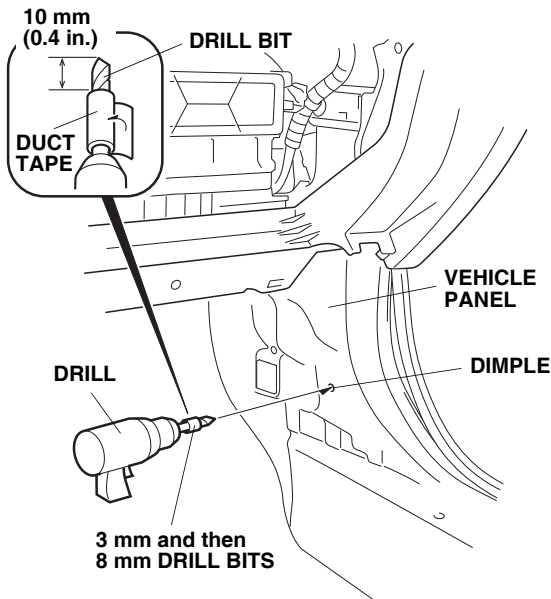

23. Using one flange bolt, one turn nut, and one washer-screw, secure the XM radio unit and bracket to the vehicle stay and to the vehicle panel.

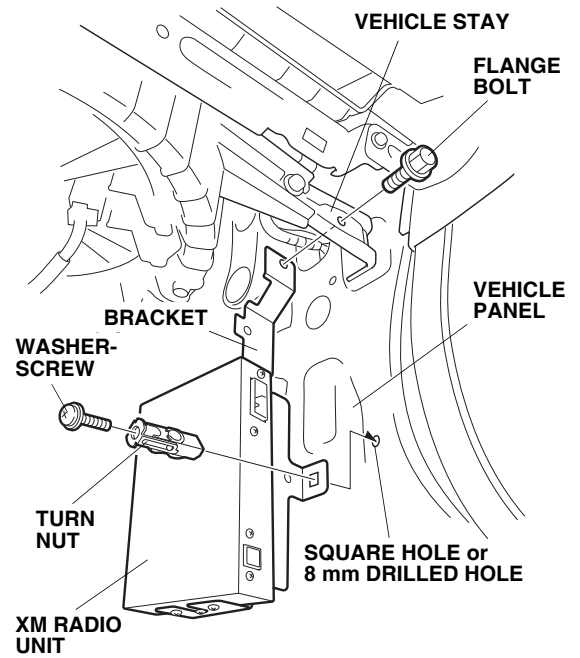

Routing the Antenna Cable

24. With isopropyl alcohol on a shop towel, clean the area shown on the inside of the front window.

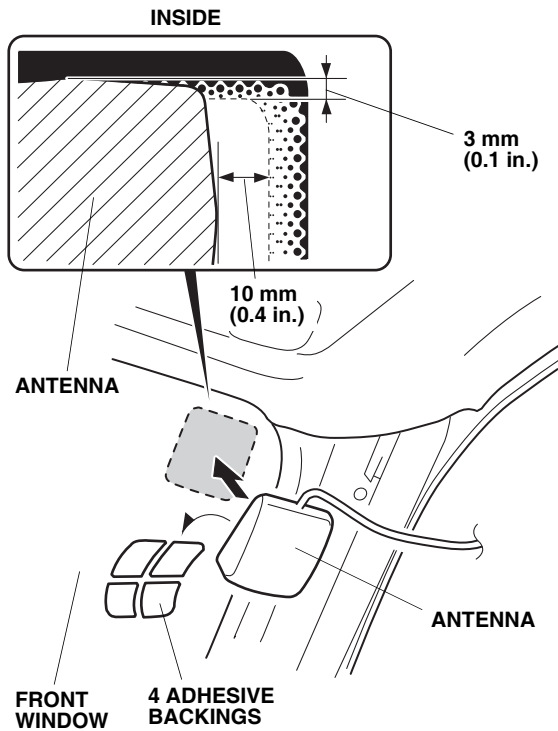

25. Remove the adhesive backings from the antenna, and attach the antenna to the location shown. Apply sufficient pressure to completely contact.

26. Attach the masking tape to the location shown.

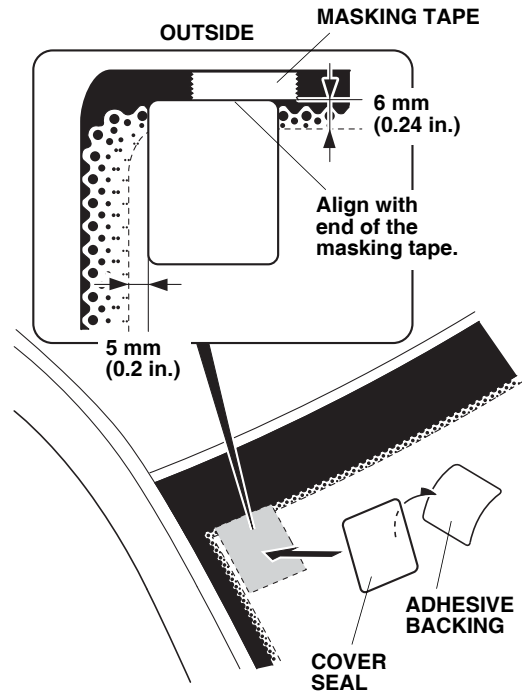

27. With isopropyl alcohol on a shop towel, clean the area shown on the outside of the front window.
28. Remove the adhesive backing from the cover seal, then attach to the location shown. Remove the masking tape.

- Route the antenna cable down along the passenger's A-pillar. Using six cushion tapes, secure the antenna cable to the A-pillar panel in the areas shown after cleaning with isopropyl alcohol on a shop towel.

NOTE: Do not attach the cushion tapes to the vehicle holes, pay attention to the orientation of cushion tapes.

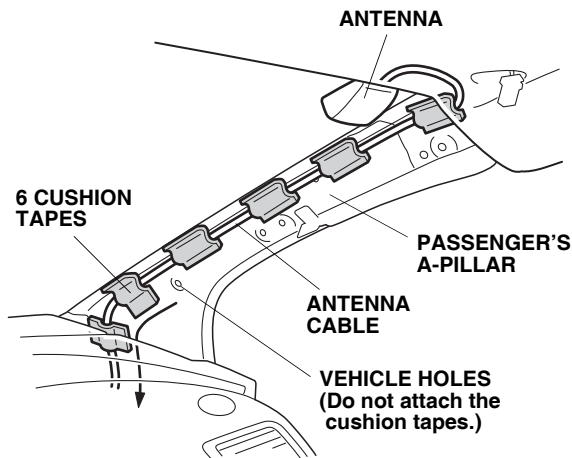

- With scissors, cut one EPT sealer in half.

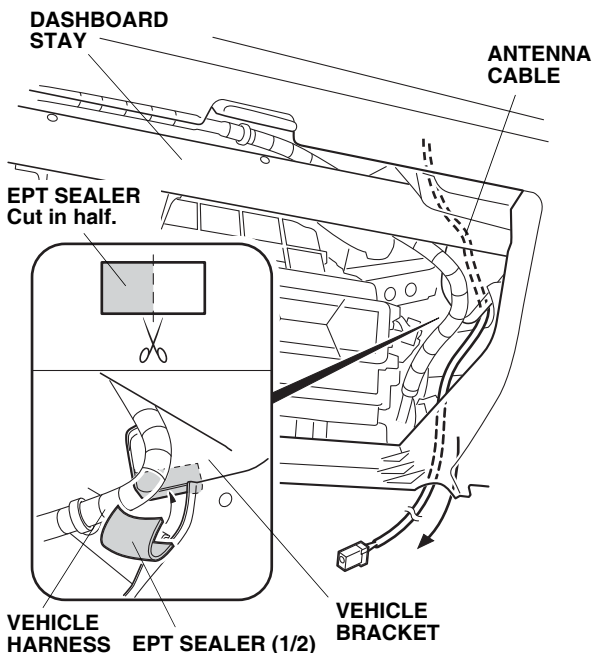

- Attach one halved piece of EPT sealer to the vehicle bracket shown after cleaning with isopropyl alcohol on a shop towel.
- Route the antenna cable down to the XM radio unit.

- Plug the antenna cable 1-pin connector and the bus cable 14-pin connector into the XM radio unit.

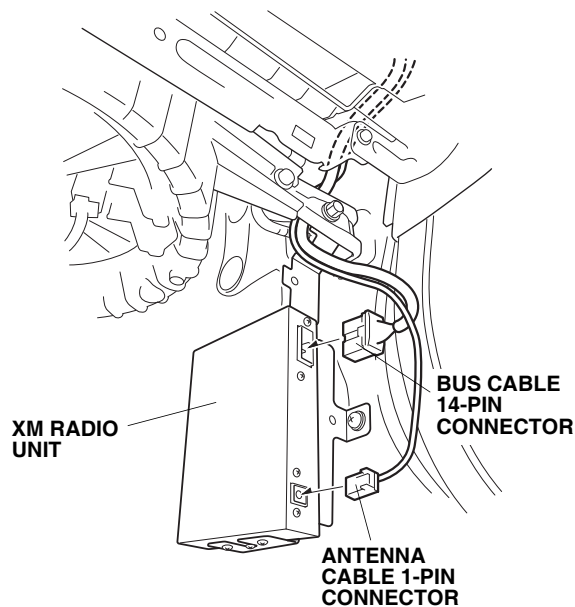

- Attach the other halved piece of EPT sealer to the antenna cable as shown.

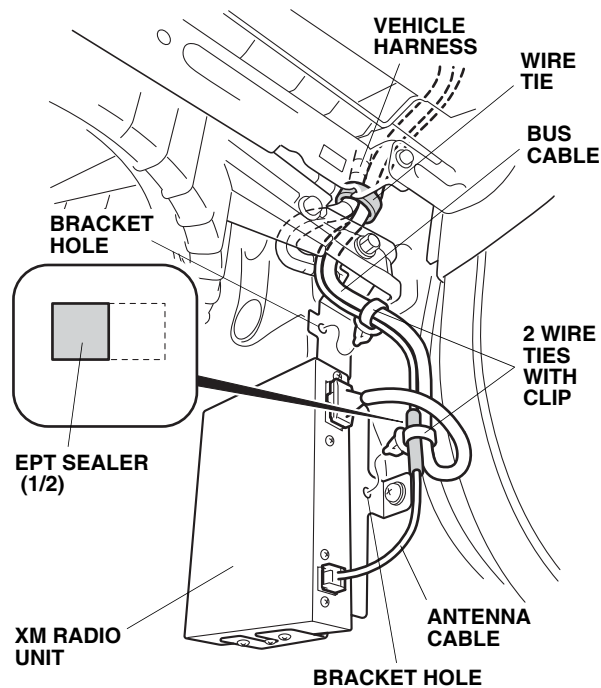

- Using two wire ties with clip, secure the antenna cable and the bus cable to the bracket holes as shown.
- Using one wire tie, secure the bus and antenna cables to the vehicle harness in the area shown.

37. Route the bus cable up along the antenna cable. Using two wire ties, secure the bus and antenna cable to the vehicle harness.

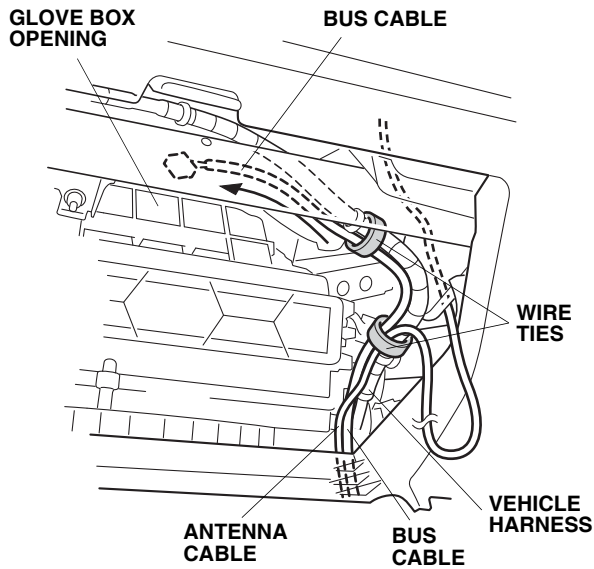

38. In the glove box opening, route the bus cable along the vehicle harness and towards the audio unit opening.

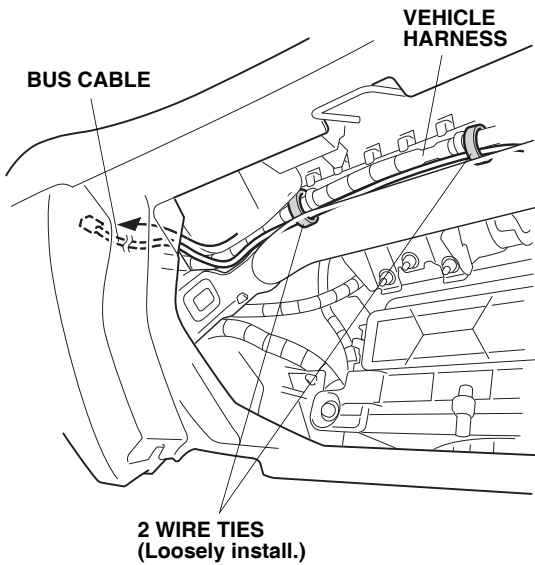

39. Using two wire ties, loosely install the bus cable to the vehicle harness.

40. Using one wire tie, secure the bus cable to the vehicle harness in the area shown.

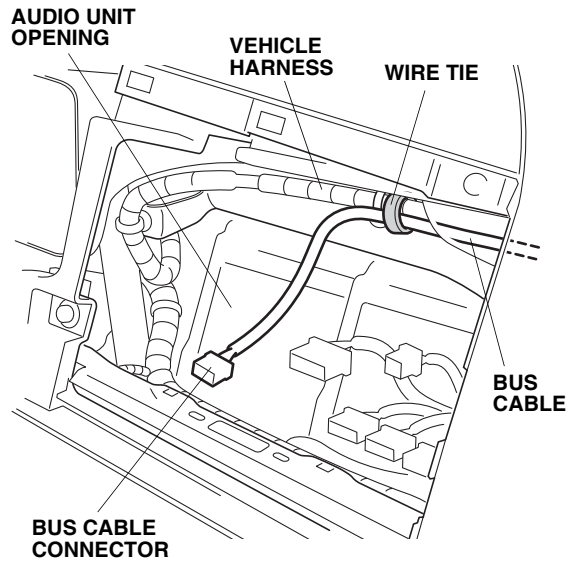

41. Bundle up the excess antenna cable as shown, and secure it to the two wire ties installed in step 39.

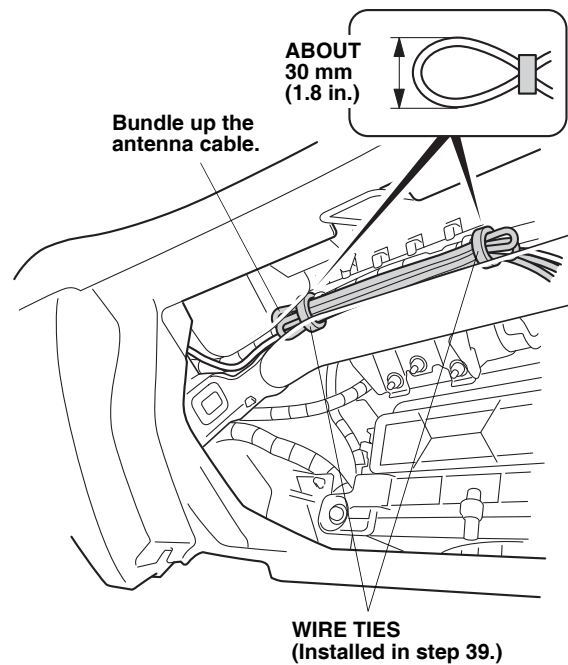

If the vehicle you're working on is equipped with CD Changer, go on to step 42; otherwise, go to step 44.

42. Plug the 2-port bus cable connectors in the two bus cables.

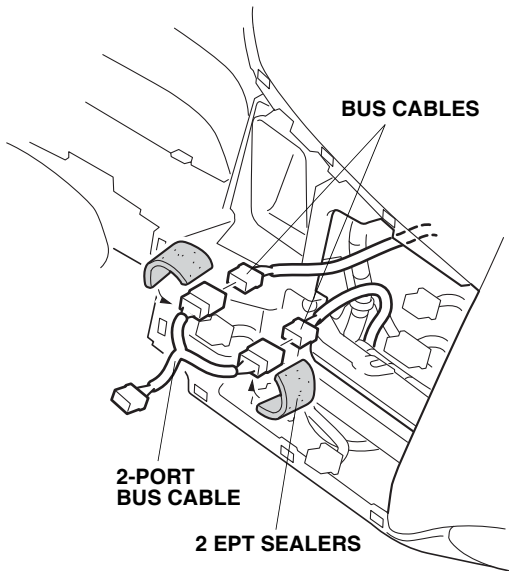

43. Using two EPT sealers, wrap the two plugged connectors.
44. Plug the bus cable connector into the audio unit.

Audio Unit for 4-door vehicle

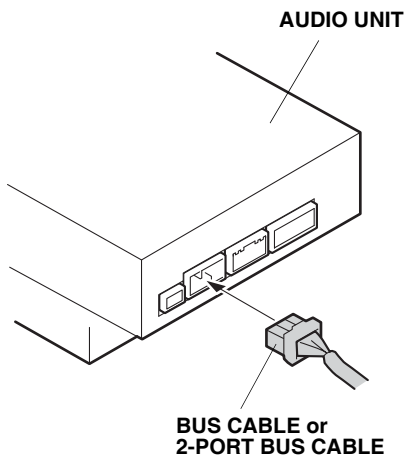

Audio Unit for 2-door vehicle

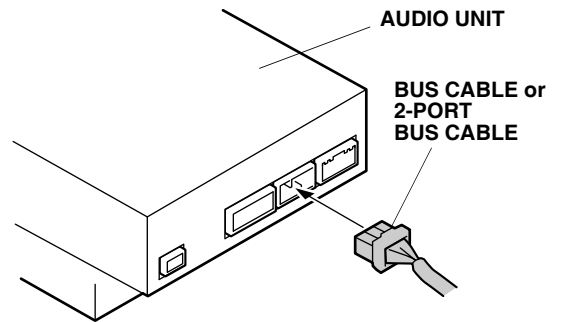

Navigation Unit

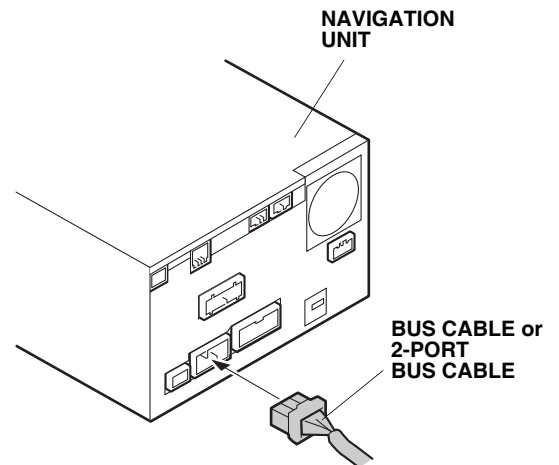

45. Plug the vehicle connectors to the center panel, and reinstall the center panel.

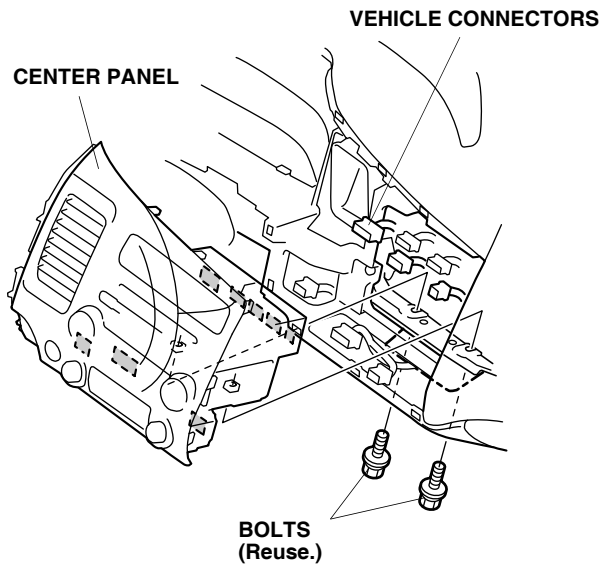

46. Replace the old clip on the right front pillar trim with a new one.

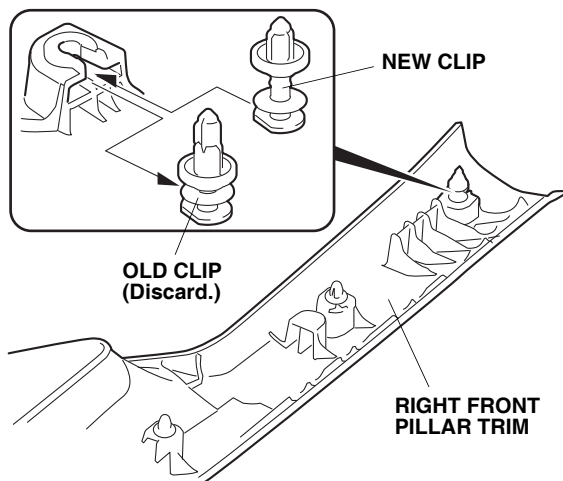

47. Check that all wire harnesses are routed properly and all connectors are plugged in.
48. Reinstall all removed parts.
49. Connect the negative cable to the battery and check operation of all lights and other electrical accessories.
50. Enter the anti-theft codes for the audio system and the navigation system (if equipped), and reset the radio station presets.
51. Reset the clock on vehicles without navigation.
52. Check the operation of the XM radio system according to the vehicle's owner's manual.