

PARTS LIST

Fog Light Attachment Kit P/N 08V31-T2A-100E

Left fog light



Right fog light



Left trim

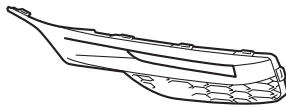

Right trim



Fog light harness

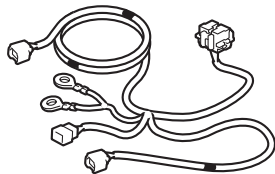

Light switch

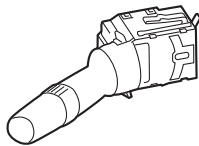

Relay

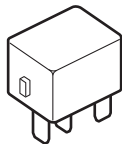

10 A Fuse

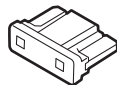

4 Wire ties

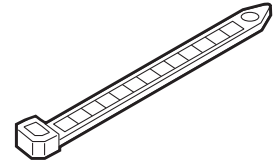

Narrow wire tie
(May not be used)

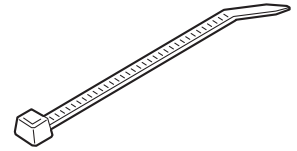

2 Clips



6 Self-tapping screws



6 Aluminium tapes

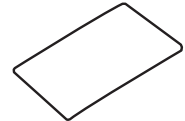

Urethane tape

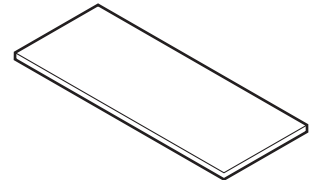

Relay Box Kit P/N 08V31-T2A-1E0

Case

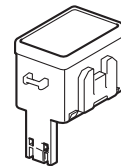

Lower cover

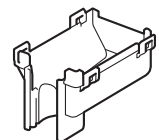

Upper cover

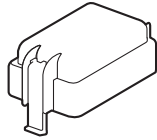

Relay bracket

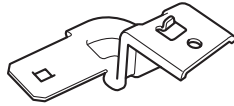

Flange bolt

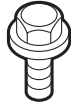

TOOLS AND SUPPLIES REQUIRED

- Phillips screwdriver
- Ratchet
- 10 mm Socket
- 10 mm Open end wrench
- Diagonal cutters
- Isopropyl alcohol
- Shop towel
- Masking tape
- Blanket
- Universal joint

The following tool is available through the Honda Tool and Equipment Program. On the iN, click on: Service > Service Bay > Tool and Equipment Program, then enter the number under "Search." Or, call 888-424-6857.

- Trim Tool Set (T/N SOJATP2014)

Illustration of the Fog Lights on the Vehicle

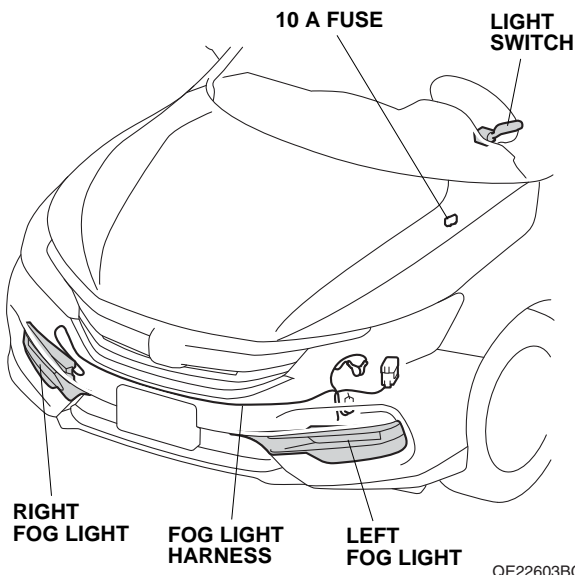

QE22603BG

INSTALLATION

Customer Information: The information in this installation instruction is intended for use only by skilled technicians who have the proper tools, equipment, and training to correctly and safely add equipment to your vehicle. These procedures should not be attempted by "do-it-yourselfers."

1. Disconnect the negative cable from the battery.
2. Turn the steering wheel 90° clockwise. Using a plastic trim tool, release the retaining tab.

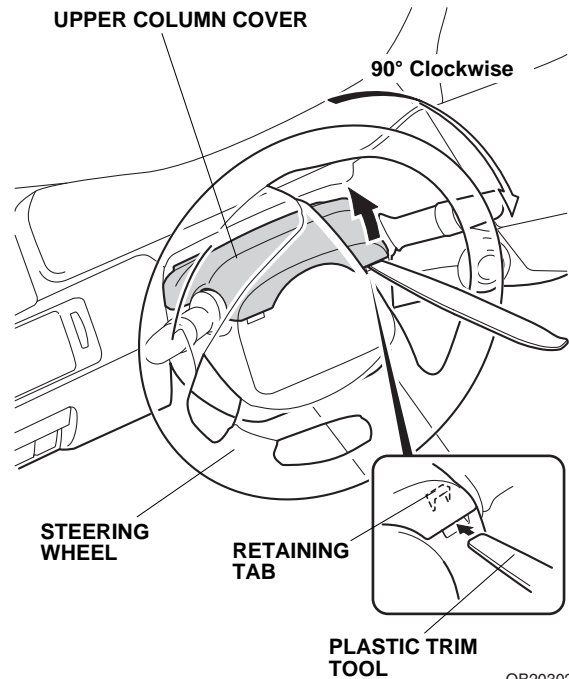

QB20302AG

- Turn the steering wheel 180° counterclockwise. Using a plastic trim tool, release the retaining tab.

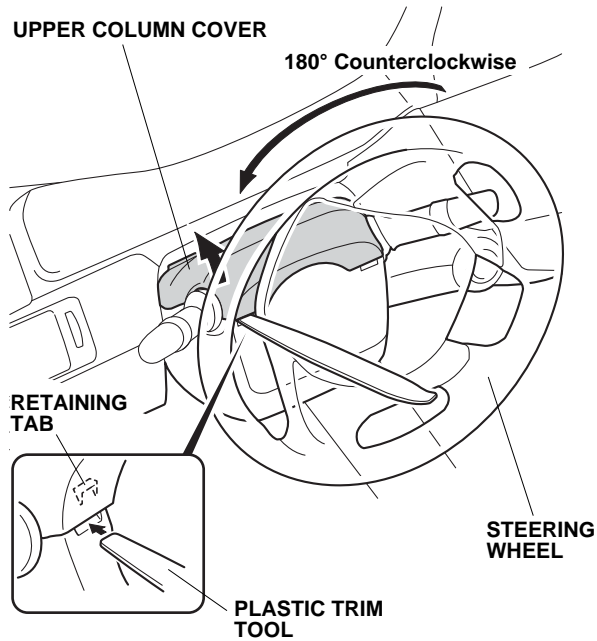

QB20303AG

- Lower the tilt lever, and release the upper column cover.

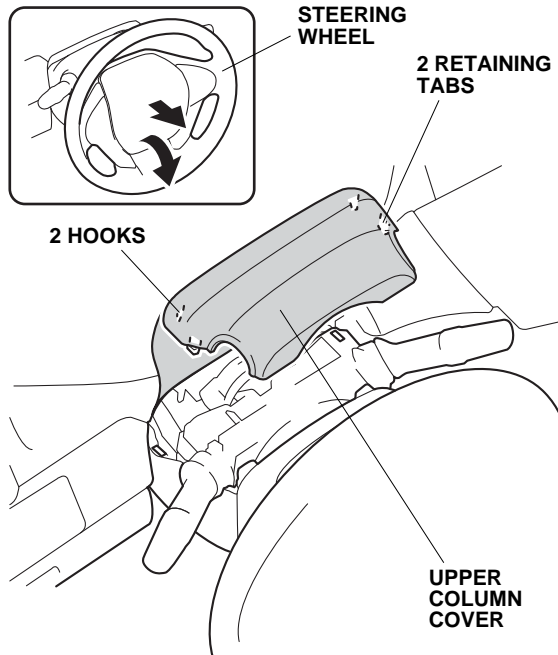

QB51801AG

- Remove the self-tapping screw from the lower column cover.

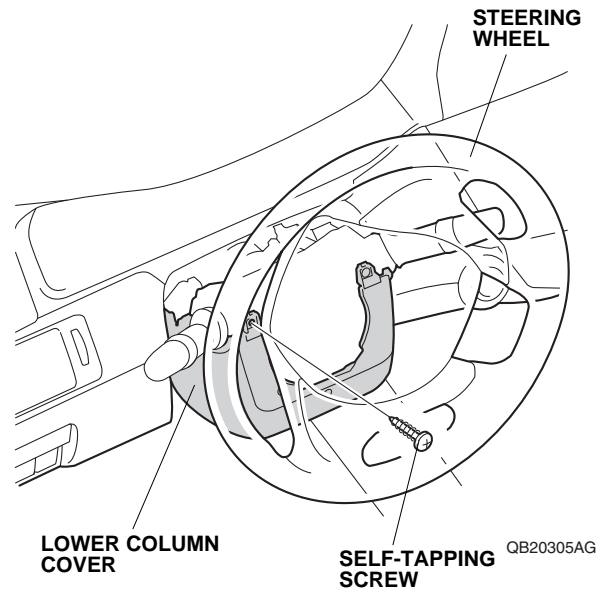

- Turn the steering wheel 180° clockwise, and remove the other self-tapping screw from the lower column cover.

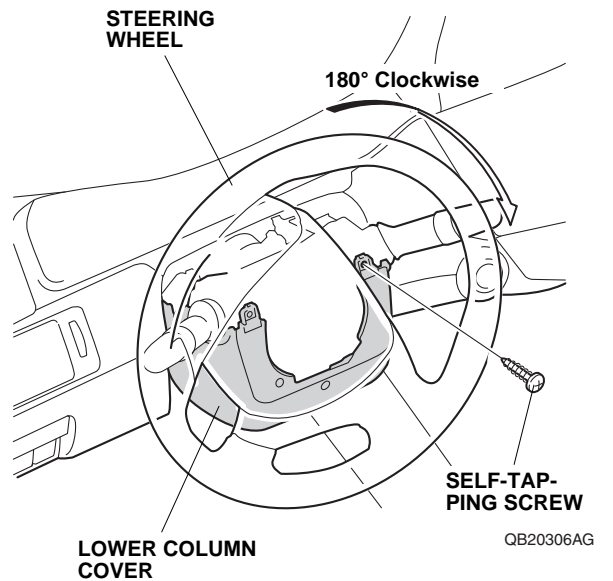

7. Remove the lower column cover.

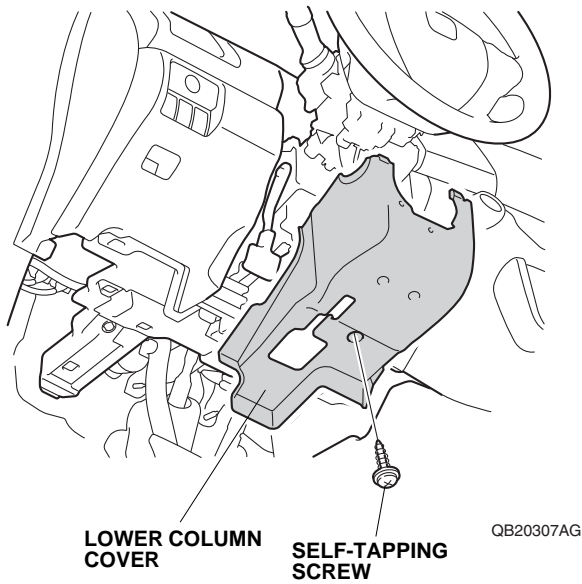

8. Unplug the vehicle connector from the light switch.

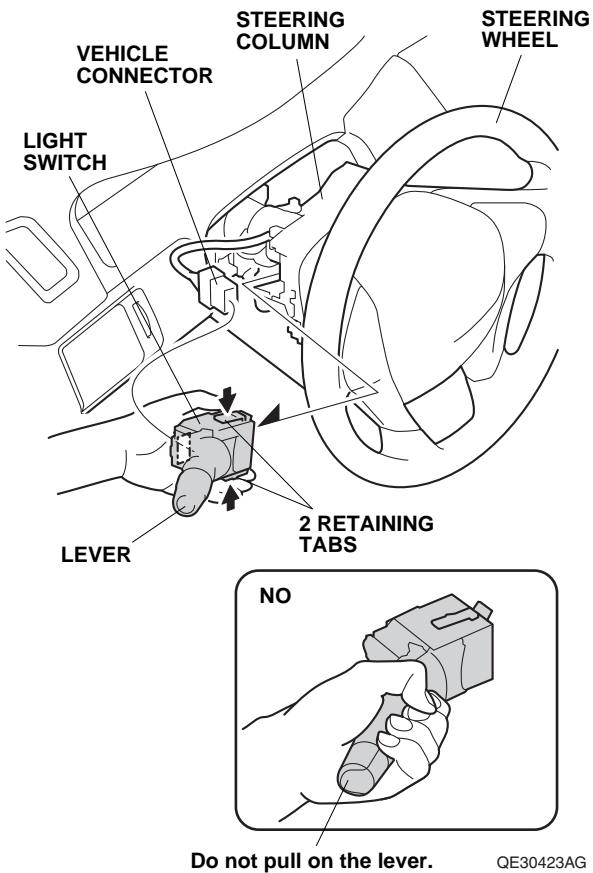

9. Push down on the two retaining tabs, slide the light switch out, and remove it from the steering column. Do not pull on the lever.

10. Install the new light switch on the steering column. Make sure both retaining tabs are locked in place. Do not push on the lever.

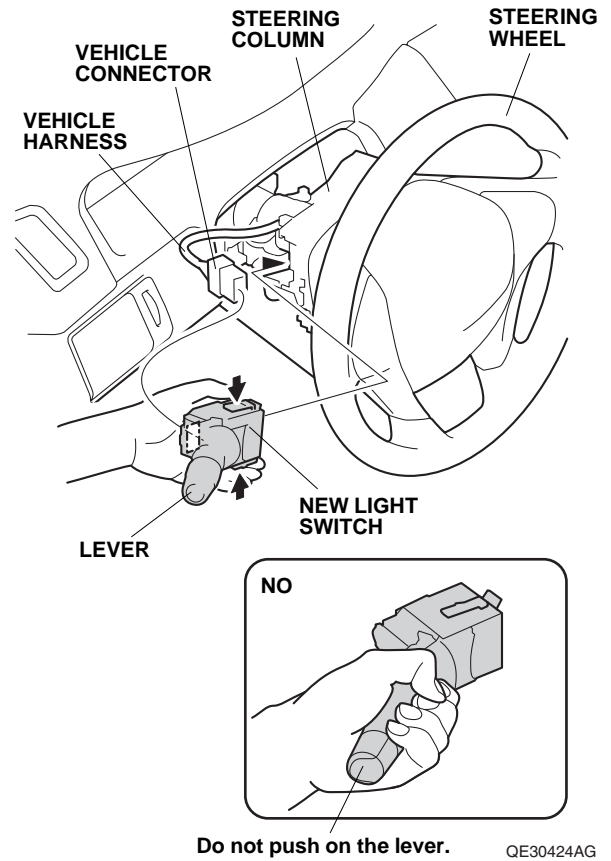

11. Plug the vehicle connector into the new light switch. Make sure the vehicle harness is not being stretched.

12. Attach masking tape to the areas shown.

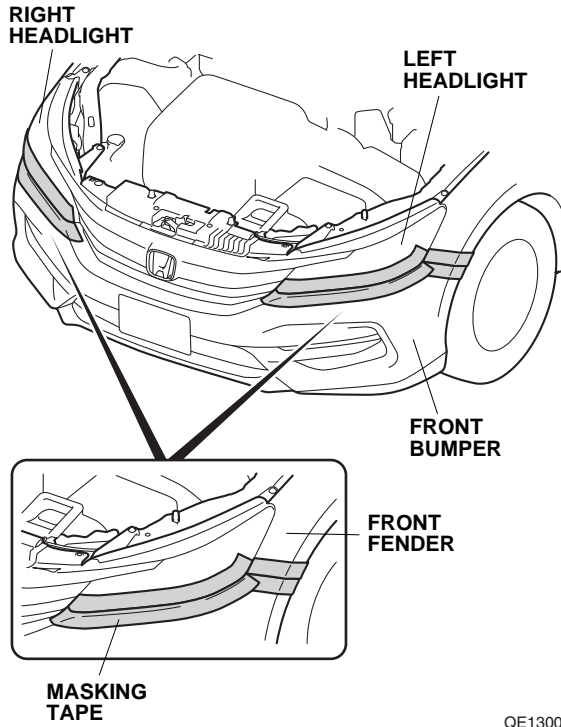

13. Remove the front grille cover.

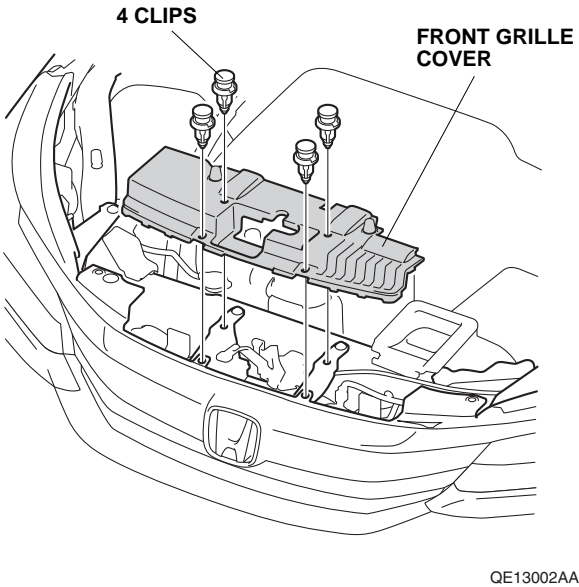

14. Remove the front bumper.

- Remove the four self-tapping screws and twelve clips.

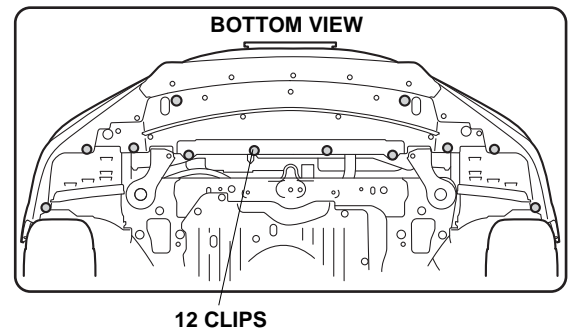
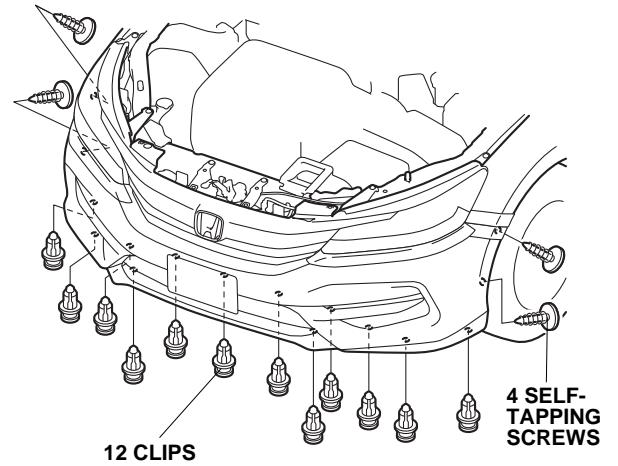

- Release the four retaining tabs on each side.

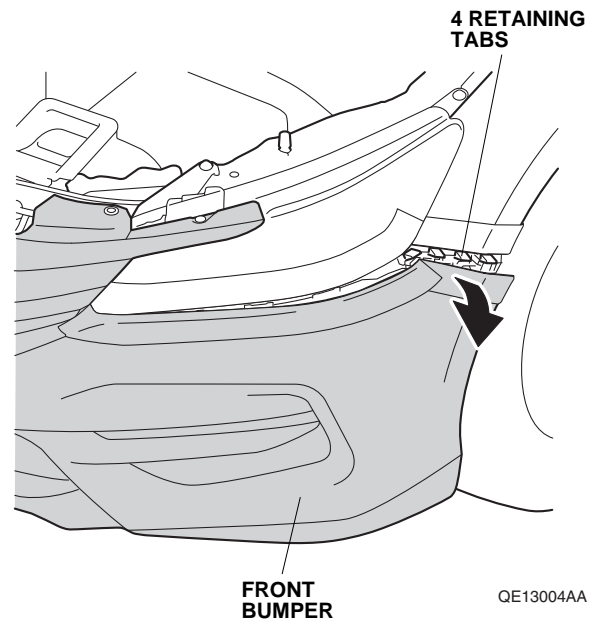

- Release the four retaining tabs on each side.

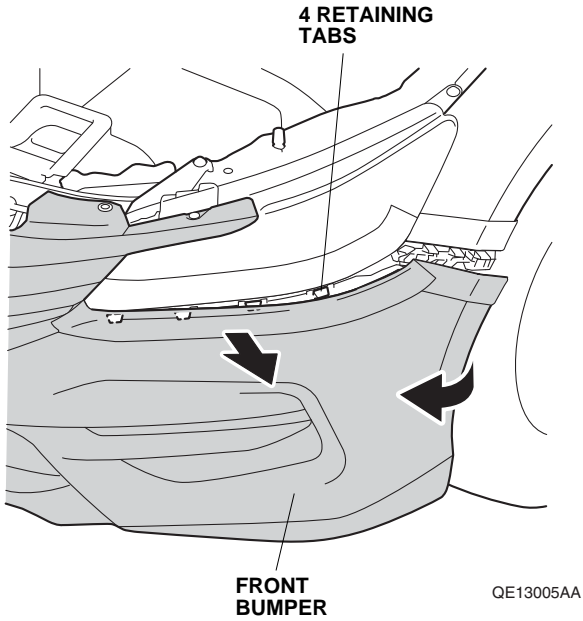

- Remove the two clips and two short clips.
- With the help of an assistant, remove the front bumper.
- Place the front bumper on a blanket.

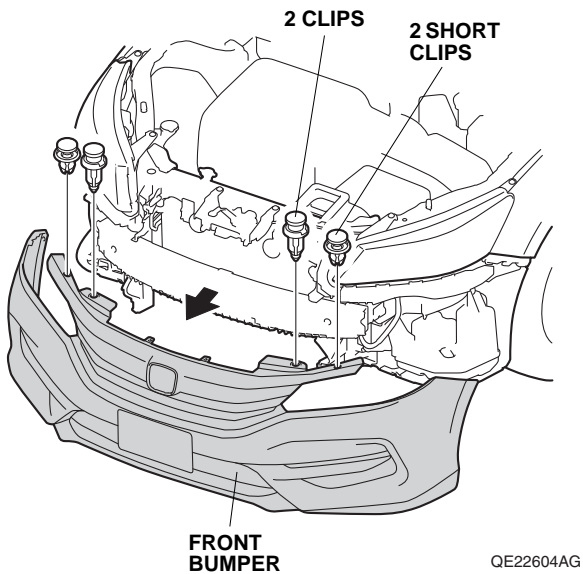

15. Remove the front bumper absorber.

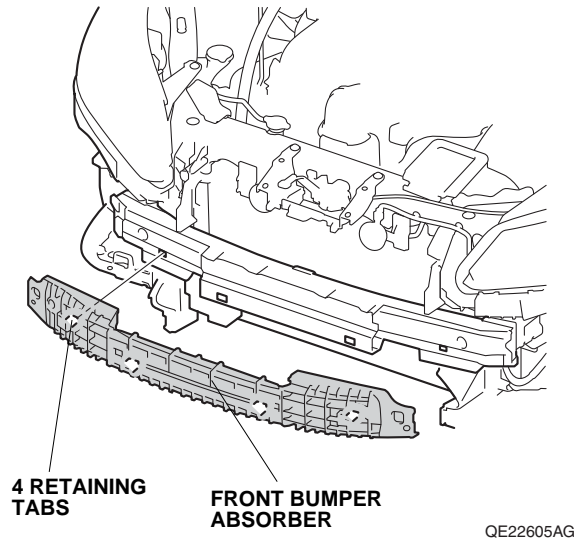

If the vehicle is equipped with LKAS and/or LED daytime running lights, continue with step 16; otherwise, go to step 19.

With LKAS and/or LED daytime running lights

16. Open the positive cable cover, and disconnect the positive cable from the battery.

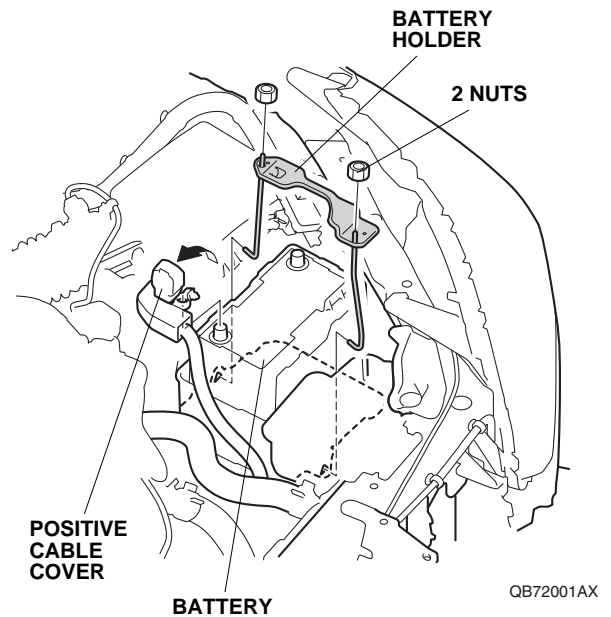

17. Remove the battery holder.

18. Remove the battery cover, battery, and battery tray.

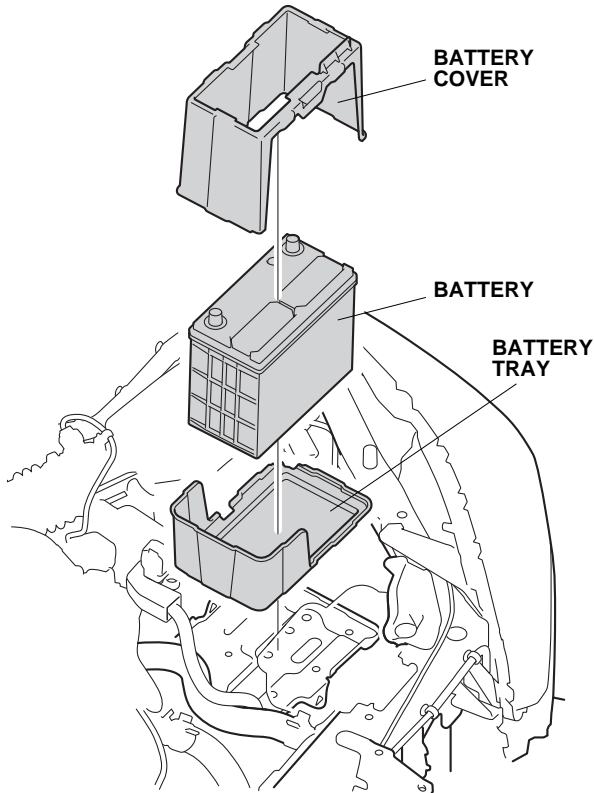

QB72002AX

19. Remove and discard the left cover from the front bumper.

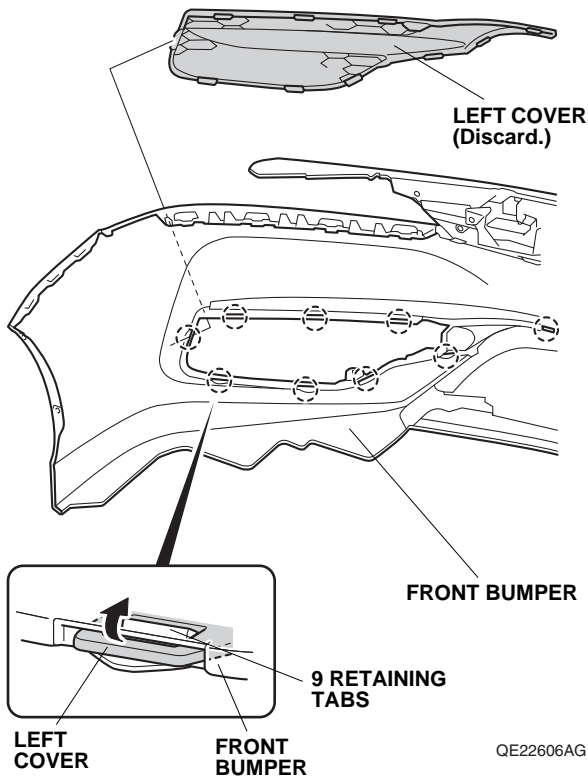

QE22606AG

20. Install the left fog light to the left trim with three self-tapping screws.

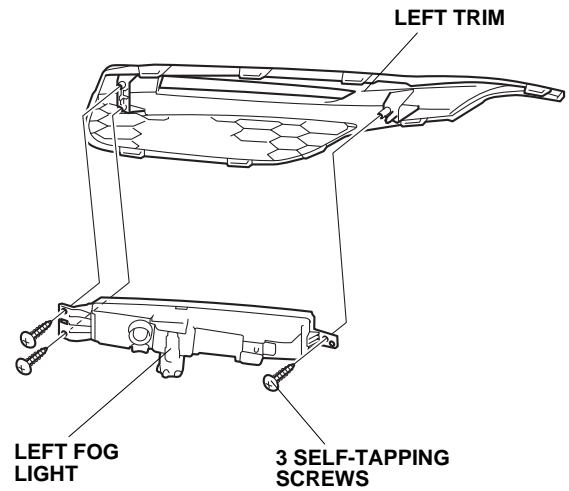

QE22607AG

21. Install the left trim on the front bumper with nine retaining tabs and one clip.

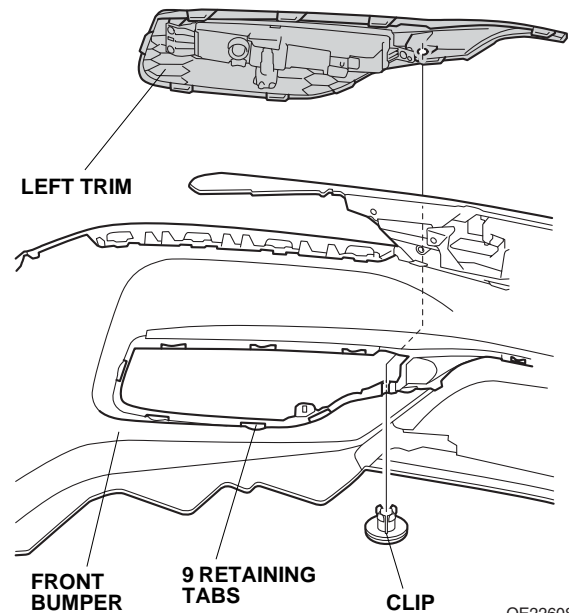

QE22608AG

22. Repeat steps 19 through 21 to install the right trim.

If the vehicle is equipped with LKAS and/or LED daytime running lights, continue with step 23; otherwise, go to step 35.

With LKAS and/or LED daytime running lights

23. Remove the vehicle relay box from the vehicle bracket.

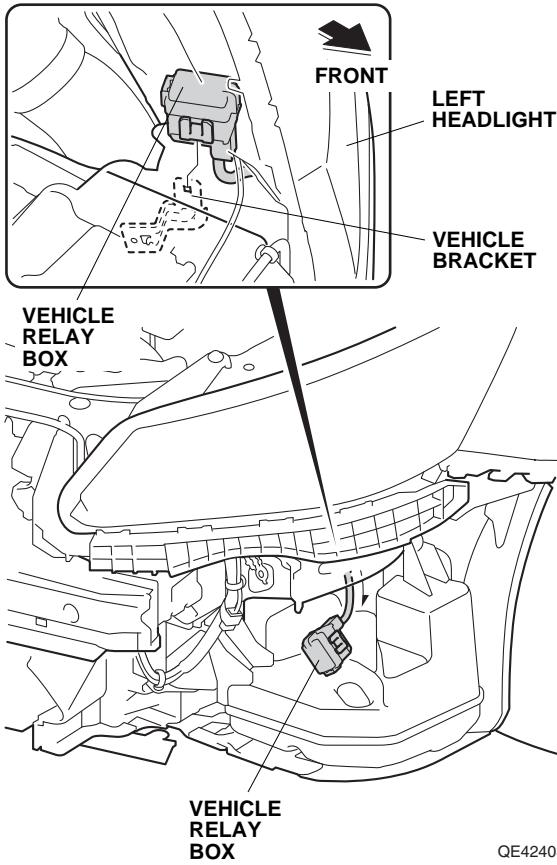

24. Remove the lower cover.

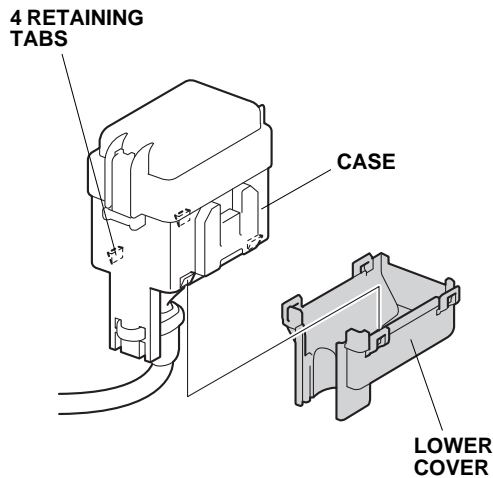

25. Remove the wire tie and urethane tape. NOTE: Be careful not to damage the vehicle harness.

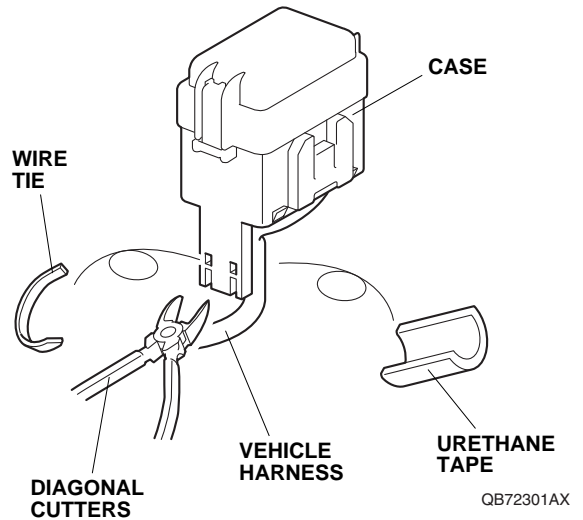

26. Remove the upper cover.

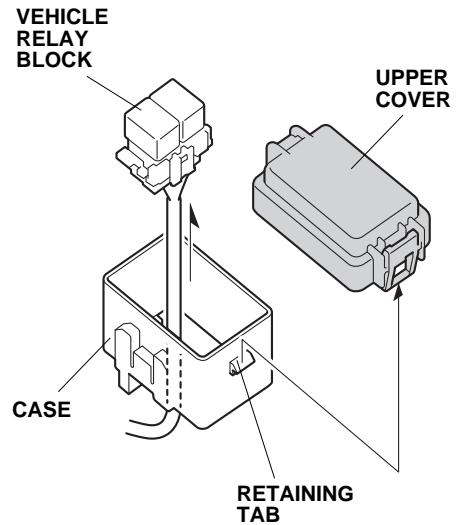

27. Release the vehicle relay block.

28. Plug the relay into the relay block on the fog light harness.

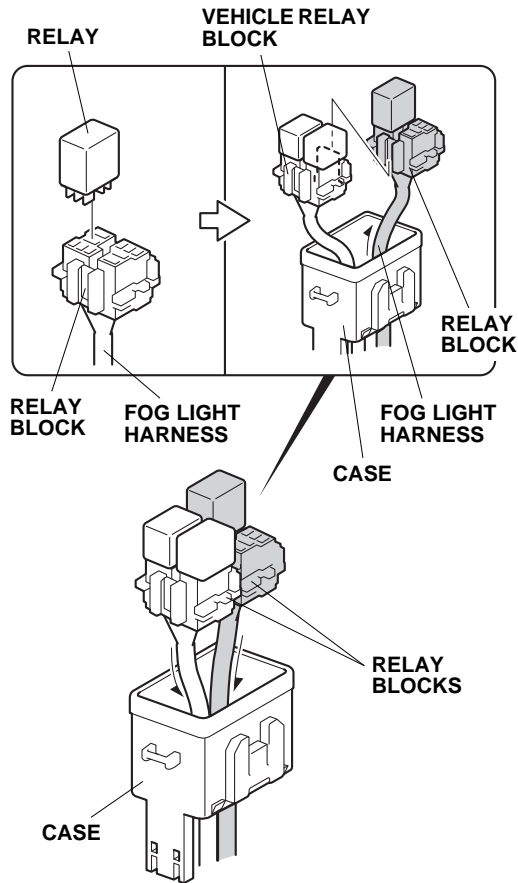

QE40903AG

29. Route the fog light harness through the case, and secure the relay block to the vehicle relay block.
 30. Install the relay blocks to the case.
 31. Install the upper cover.

32. Wrap the vehicle harness and fog light harness with urethane tape as shown, then secure the vehicle harness and fog light harness to the case with one narrow wire tie.

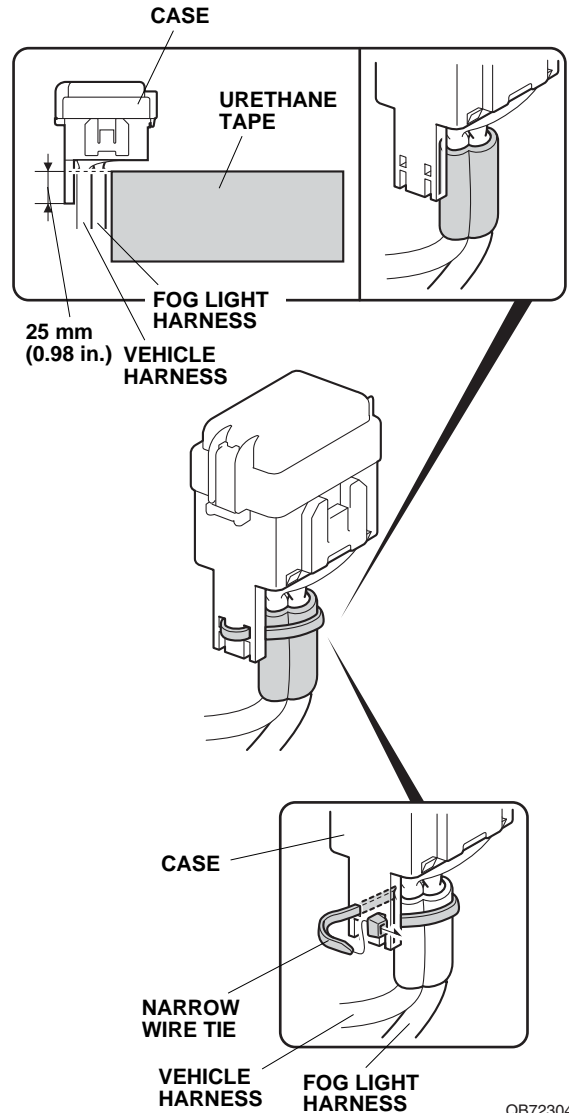

QB72304BX

33. Reinstall the lower cover.
 34. Reinstall the vehicle relay box. Go to step 42.

Without LKAS and/or LED daytime running lights

35. Plug the relay into the relay block on the fog light harness.

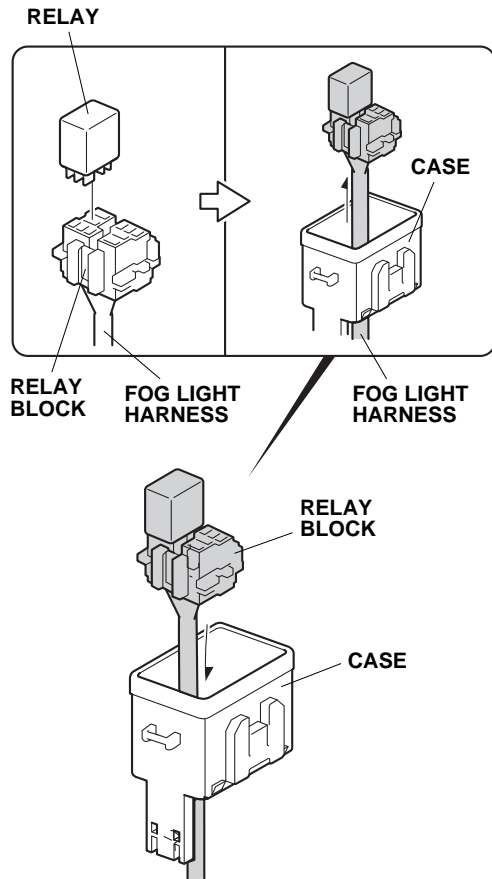

36. Route the fog light harness through the case, and install the relay block in the case.

37. Install the upper case cover.

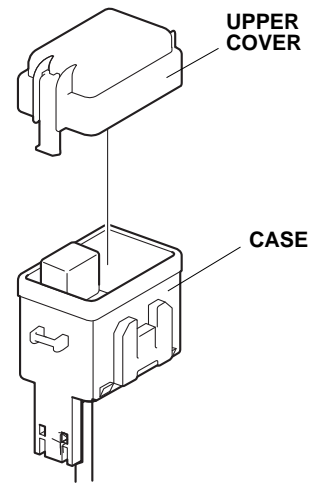

38. Wrap the fog light harness with urethane tape as shown, then secure the fog light harness to the case with one narrow wire tie already attached.

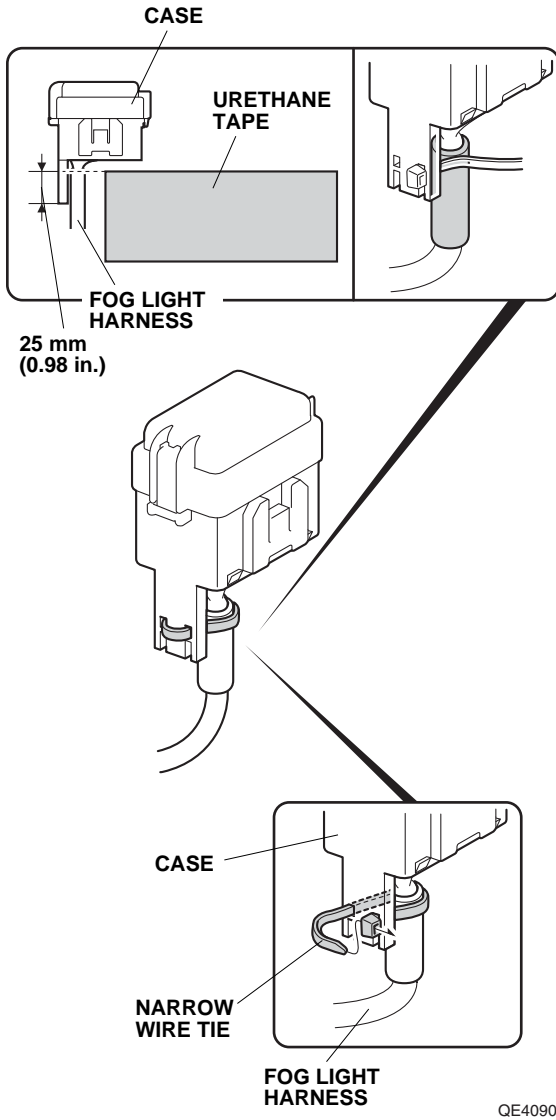

39. Install the lower case cover.

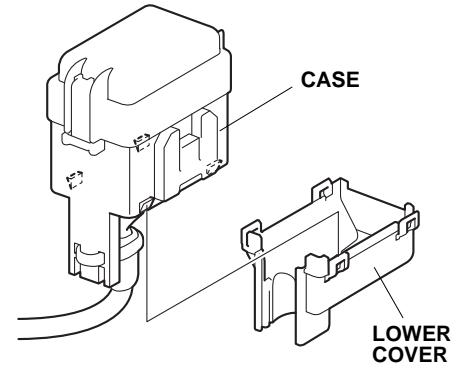

40. Install the relay bracket to the vehicle panel with one flange bolt.

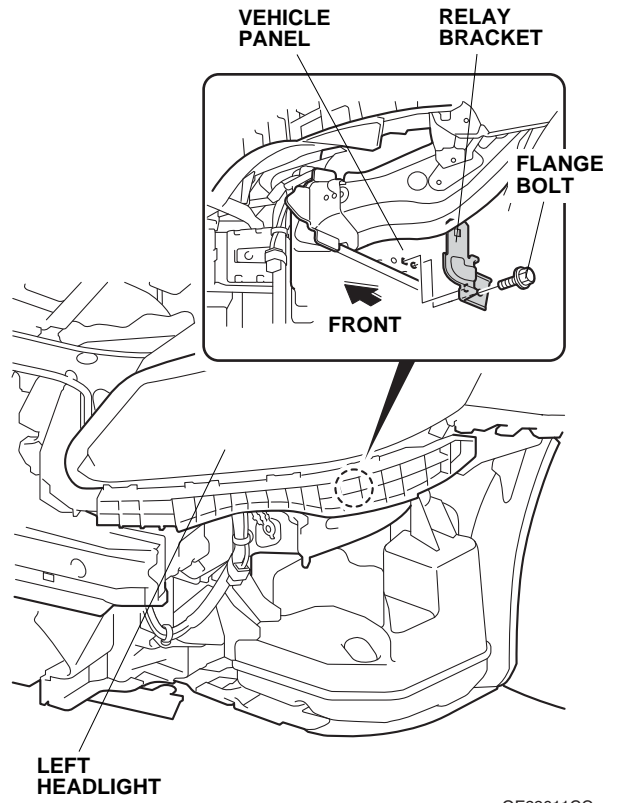

41. Install the case on the relay bracket.

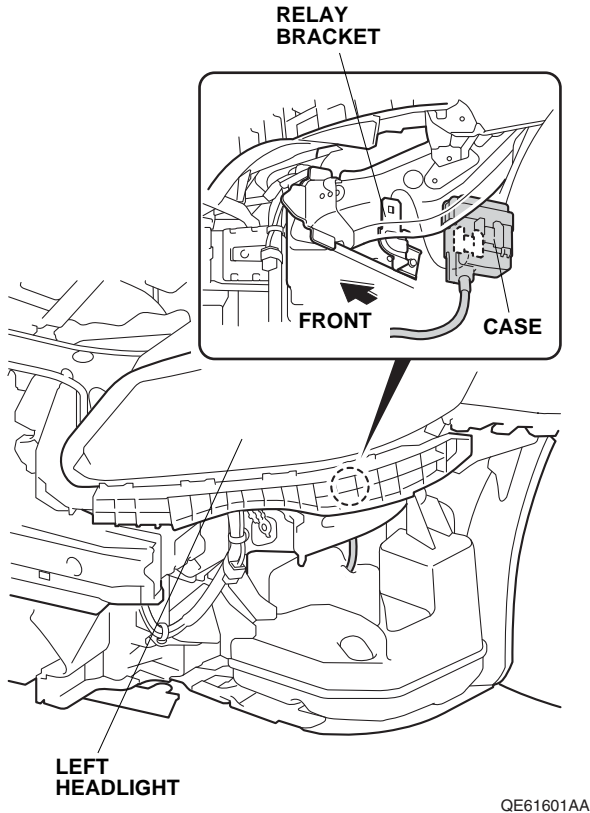

42. Route the fog light harness as shown. Remove the vehicle ground bolt, and secure the fog light harness ground terminals A and B to the vehicle ground terminal. Install the vehicle ground bolt.

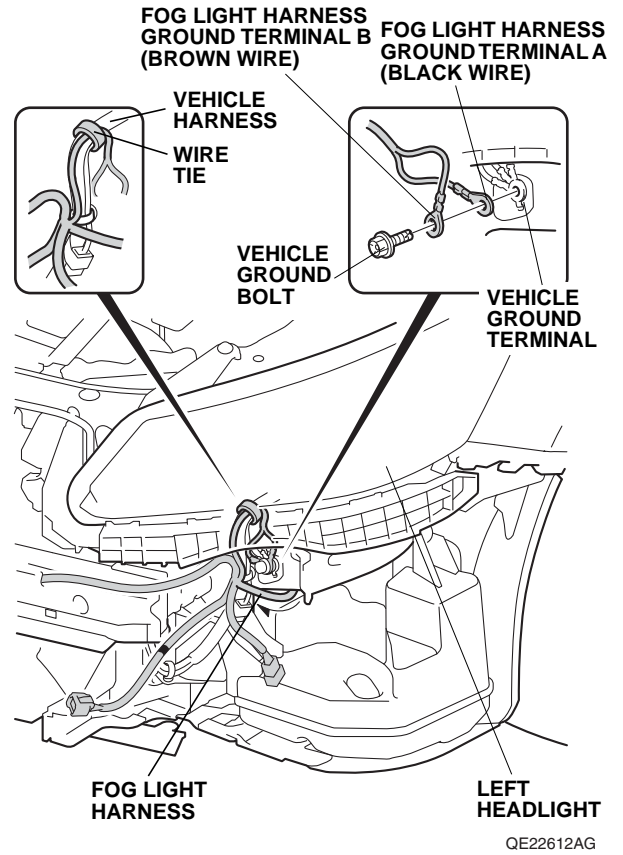

43. Secure the fog light harness to the vehicle harness with one wire tie.

44. Locate the vehicle 2-pin connector taped to the vehicle harness. Remove the tape to free the vehicle 2-pin connector.

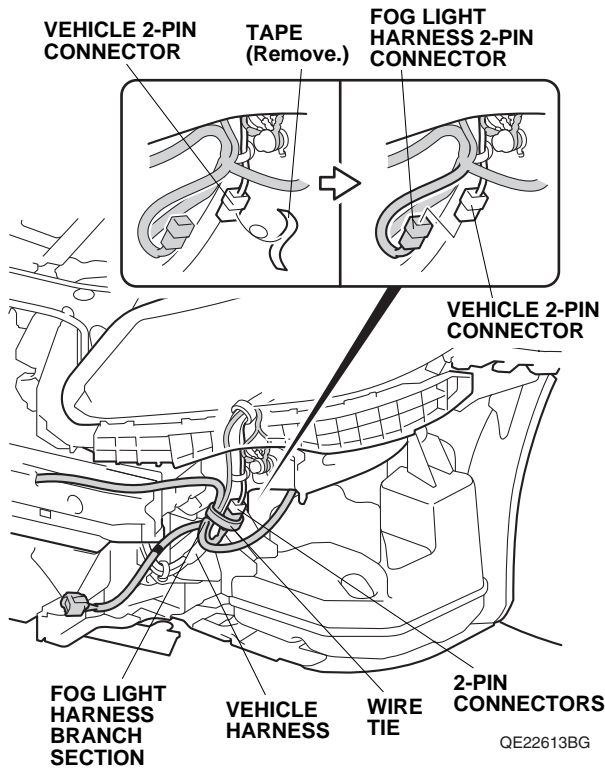

45. Plug the vehicle 2-pin connector into the fog light harness 2-pin connector, and secure the 2-pin connectors and the fog light harness to the vehicle harness with one wire tie.
46. Align the green tape on the fog light harness with the vehicle clip, and secure the fog light harness to the vehicle harness with one wire tie.

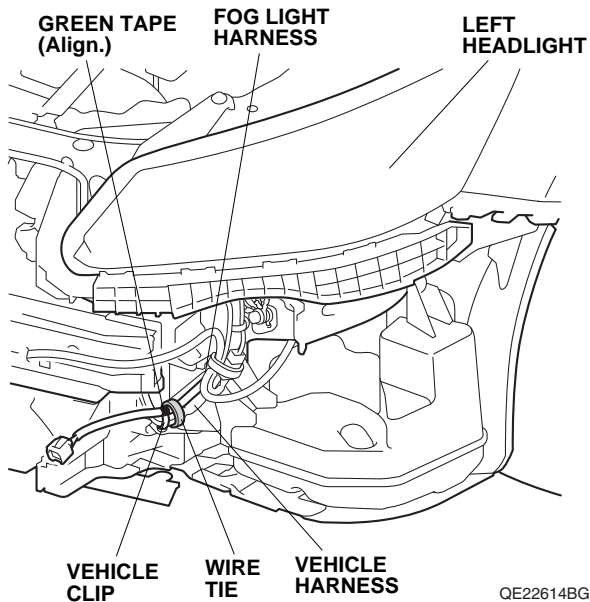

47. Route the fog light harness along the front bumper beam.

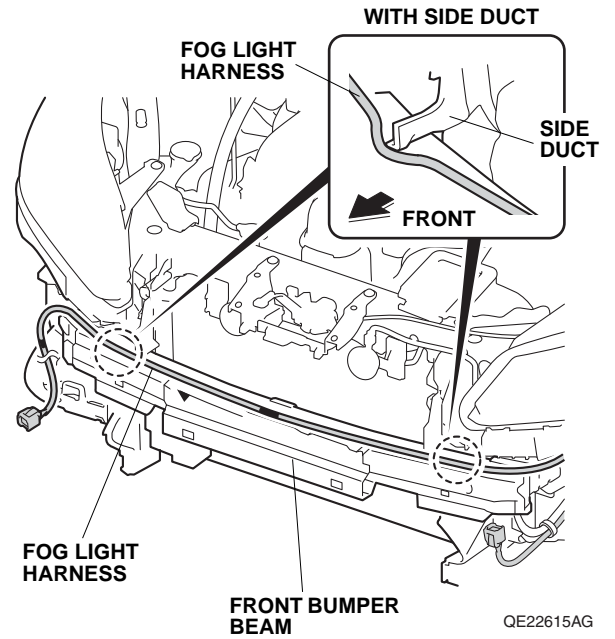

48. Align the green tape on the fog light harness with the vehicle clip, and secure the fog light harness to the vehicle harness with one wire tie.

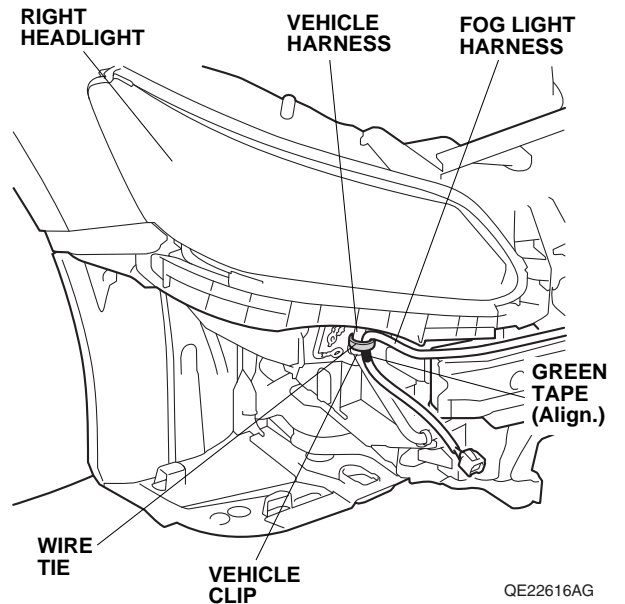

49. Using isopropyl alcohol on a shop towel, thoroughly clean the front bumper beam where the aluminium tape will attach.

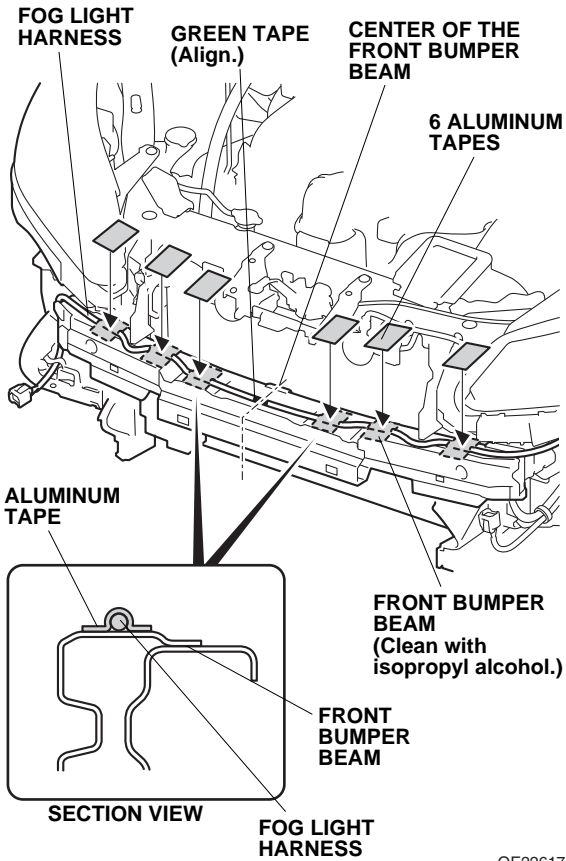

QE22617BG

50. Align the green tape on the fog light harness with the center of the front bumper beam, and secure the fog light harness to the front bumper beam with six aluminum tapes.

51. Reinstall the front bumper absorber.

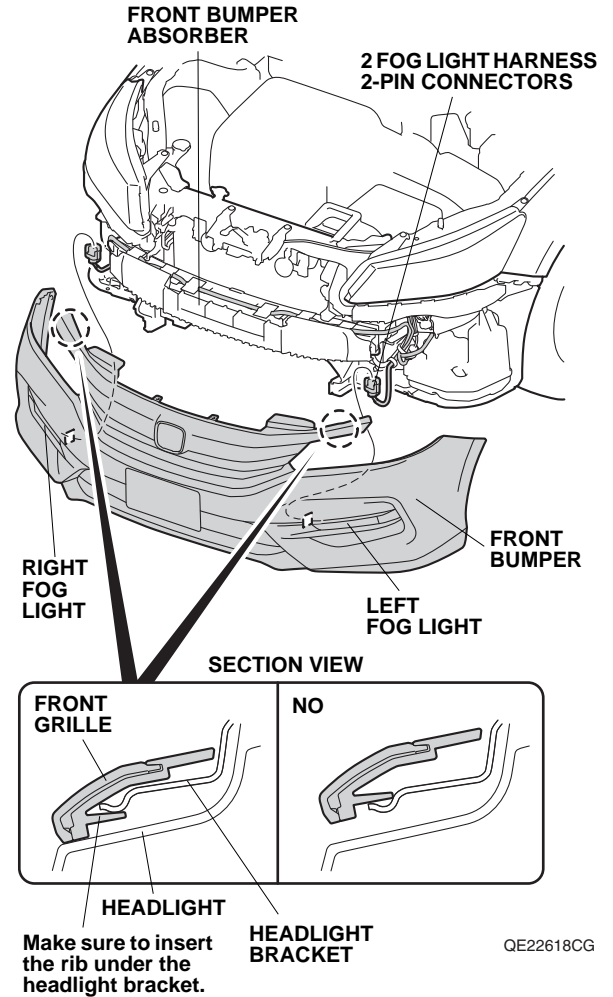

QE22618CG

52. With the help of an assistant, bring the front bumper close to the vehicle. Plug the two fog light harness 2-pin connectors into the left fog light and right fog light, then reinstall the front bumper.

53. Under the hood, remove the under-hood fuse/relay box cover.

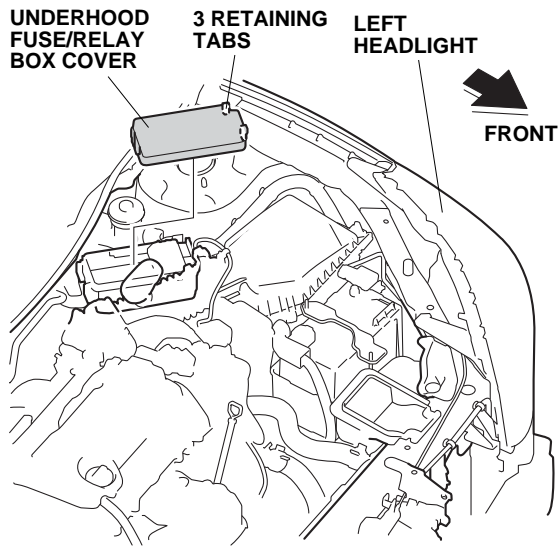

QB20809AG

54. Plug the 10 A fuse into the under-hood fuse/relay box.

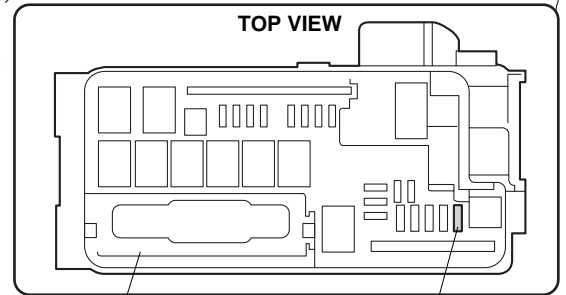
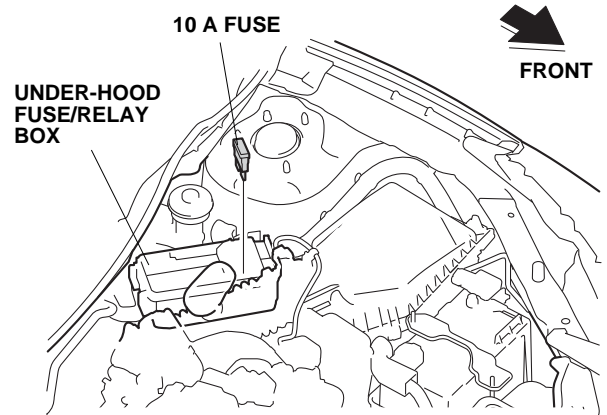

QB20810AG

55. Check that all wire harnesses are routed properly and all connectors are plugged in.
56. Install all removed parts.
57. Connect the negative cable to the battery.
58. Press and hold the audio unit power button for 2 seconds to restore the audio and navi (if equipped) system functions.
59. Reset the clock (vehicles without navigation).

Check the Operation of the Fog Lights

- Turn the headlight switch to the AUTO or “ \equiv D” position (headlights on low beam).
- Turn on the fog light switch (indicator is on).
- If the fog lights do not turn on, check the fuse and all the connectors, including the ground cable.

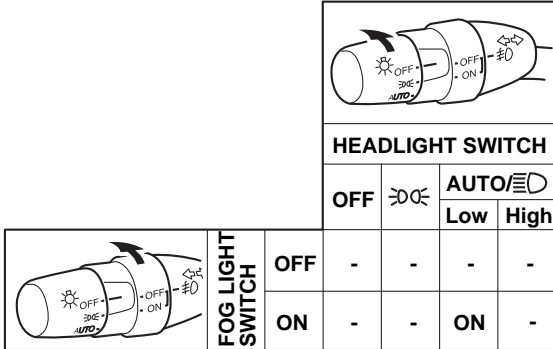

The diagram shows a fog light switch on the left and a headlight switch on the right. The fog light switch has positions for OFF, ON, and AUTO. The headlight switch has positions for OFF, AUTO, and a combined Low/High position.

		HEADLIGHT SWITCH			
		OFF	\equiv	AUTO/ \equiv D	
				Low	High
FOG LIGHT SWITCH	OFF	-	-	-	-
	ON	-	-	ON	-

922602AG

NOTE: The fog light lenses may cloud when the outside temperature is cold; this is normal and should go away in warm weather.

How to Aim the Fog Lights

60. Adjust the fog light aim by turning the adjustment screw in or out until the correct aim is obtained. Adjust the aim according to local laws and regulations.

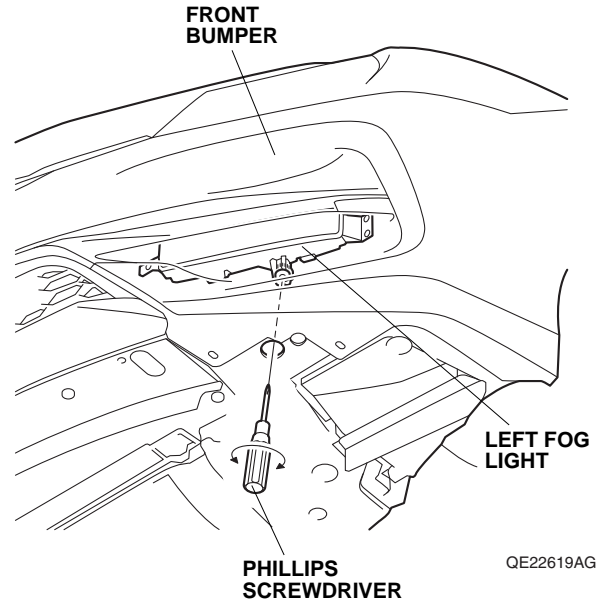

LED REPLACEMENT

NOTE: The fog light (LED) is a part of the fog light assembly, and cannot be replaced by itself.